



**SHERATON GRAND
NASHVILLE DOWNTOWN HOTEL**

623 Union Street
Nashville, TN 37219
T 615 259 2000

sheratonnashvilledowntown.com



**Sheraton
Grand**

NASHVILLE DOWNTOWN



28TH FLOOR

11TH FLOOR

7TH FLOOR

6TH FLOOR

5TH FLOOR

4TH FLOOR

3RD FLOOR

2ND FLOOR

1ST FLOOR /
LOBBY LEVEL

LOWER LEVEL

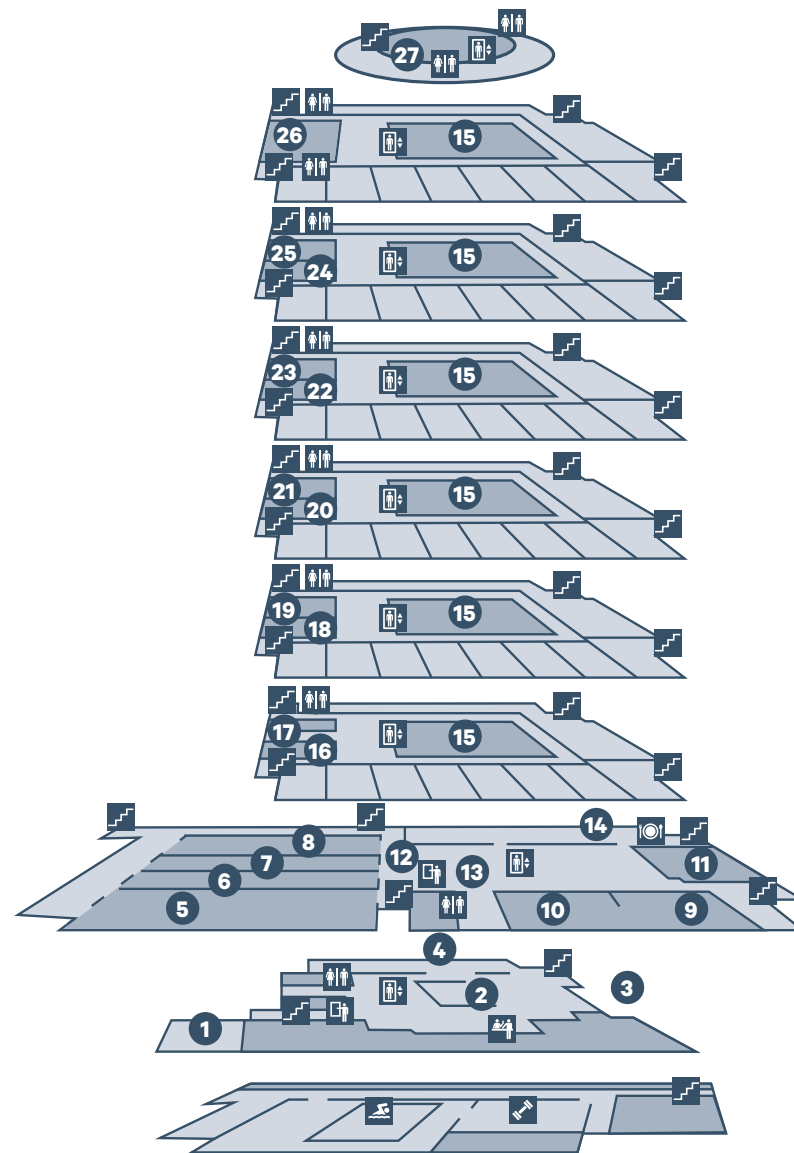

KEY

- 1 Capitol Boardroom
- 2 Lobby
- 3 Main Entrance
- 4 Library Bar
- 5 Platinum Ballroom 1
- 6 Platinum Ballroom 2
- 7 Platinum Ballroom 3
- 8 Platinum Ballroom 4
- 9 Melody Room A
- 10 Melody Room B
- 11 Legislative Terrace
- 12 Platinum Foyer
- 13 Lobby
- 14 Broadway Kitchen
- 15 Atrium
- 16 Studio 3
- 17 Executive Boardroom
- 18 Studio 4A
- 19 Studio 4B
- 20 Studio 5A
- 21 Studio 5B
- 22 Studio 6A
- 23 Studio 6B
- 24 Studio 7A
- 25 Studio 7B
- 26 Studio 11
- 27 Skye

Sheraton Grand Nashville Downtown Hotel

Whether hosting an intimate meeting for a board of directors or a fundraising gala for 1300, our modern, airy interiors and fresh design are sure to impress your guests.

MEETING SPACE

Your attendees will be sure to remember their wonderful experiences at the Sheraton Grand Nashville Downtown Hotel. We offer 20 different spaces with over 30,000 square feet of flexible event space and offer the best in meeting service and technology. One of our dedicated, highly trained executive meeting specialists will be at your side throughout your event to help you and your guests have successful, memorable meetings.

MUSIC CITY

Sheraton Grand Nashville Downtown Hotel is in the heart of Music City and just blocks away from the best Nashville attractions, such as the historic 2nd Avenue Entertainment District, Printer's Alley, Country Music Hall of Fame, The Ryman, and Frist Center for the Visual Arts. Nissan Stadium, home of the Tennessee Titans, and Bridgestone Arena, home of the Nashville Predators, are also nearby for the sports enthusiast to enjoy. The Music City Center, Nashville's 1.2 million square foot convention and exhibit hall, is less than a 10 minute walk from our hotel.

GUESTROOMS AND SUITES

Find the perfect combination of comfort and style in our 482 beautifully-appointed hotel rooms, including 5 Executive Suites, 2 Governor Suites and 1 Presidential Suite. A great night's sleep begins and ends with the celebrated comfort of the luxurious Sheraton Sweet Sleeper™ Beds.

GATHER OVER A MEAL

Sheraton Grand Nashville Downtown Hotel offers three distinct dining options for guests. Our restaurant offers modern American Cuisine and serves full breakfast options daily. Our lobby lounge features an extensive wine, beer, and cocktail list plus delicious lunch and dinner options. Both restaurants feature menus influenced by LA's two-star Michelin chef. In-room dining is available in the privacy of your guestroom every day from 6:00 am – 11:00 pm.





Meeting & Event Spaces

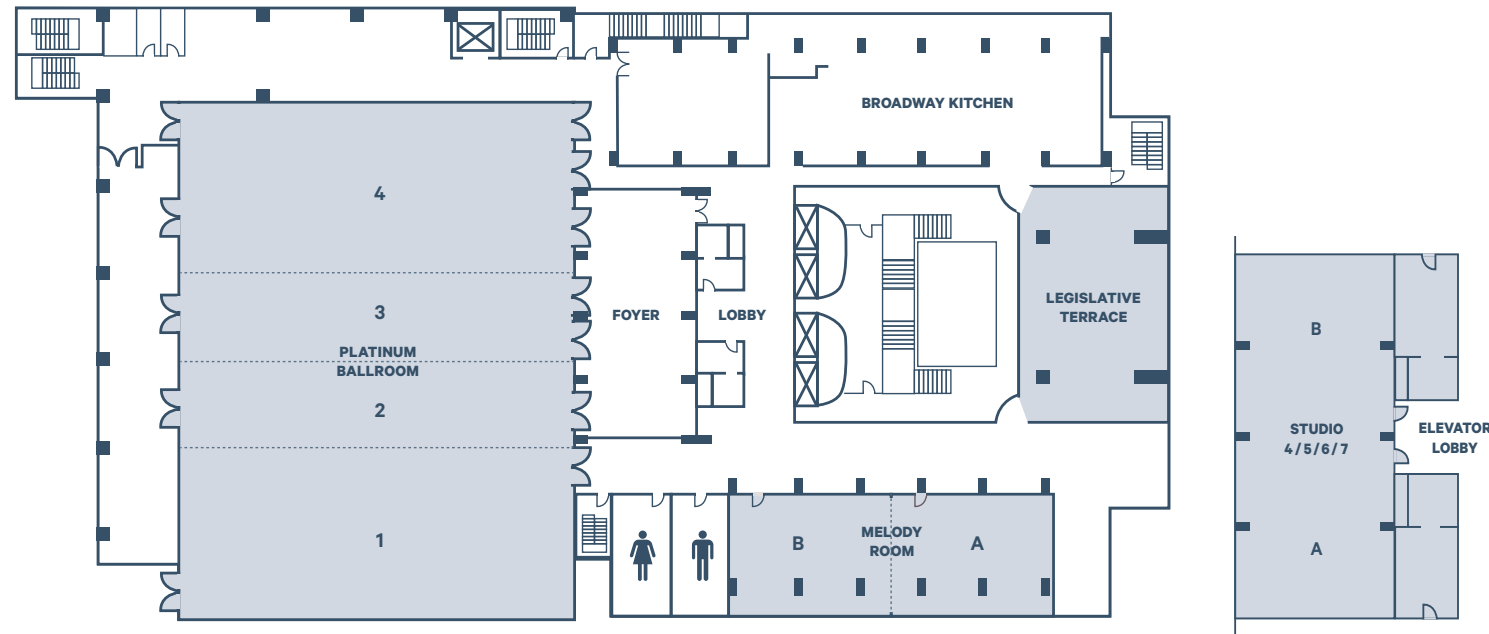

EVENT SPACE

Platinum Ballroom

- Ballroom 1
- Ballroom 2
- Ballroom 3
- Ballroom 4

Melody Room

- Melody A
- Melody B

Legislative Terrace

Broadway Kitchen

Studio 4 / 5 / 6 / 7

- Studio A
- Studio B

Capacity Chart

ROOM DIMENSIONS AND SEATING CAPACITY

MEETING ROOM NAME	SQ FEET	DIMENSIONS	HEIGHT	BANQUET	CRESCENT	THEATER	RECEPTION	CLASS	U-SHAPE	CONF
PLATINUM BALLROOM	10,680	89' X 120'	22'	550	330	900	1,300	600	250	-
BALLROOM 1	3,560	89' X 40'	22'	200	120	330	450	180	70	80
BALLROOM 2/3	3,560	89' X 40'	22'	200	120	330	450	180	70	80
BALLROOM 4	3,560	89' X 40'	22'	200	120	330	450	180	70	80
BALLROOM 1/2 OR 3/4	5,340	89' X 60'	22'	300	180	500	675	270	90	100
BALLROOM 1/2/3 OR 2/3/4	7,120	89' X 80'	22'	400	240	650	900	360	100	120
PLATINUM FOYER	1,210	22' X 55'	7'6"	-	-	-	100	-	-	-
MELODY ROOM	2,070	69' X 30'	9'	120	72	190	220	90	50	50
MELODY A OR B	1,035	34' X 30'	9'	60	36	100	110	40	30	30
STUDIO 3	560	24' X 24'	9'	40	24	50	50	30	15	20
STUDIO 4, 5, 6, 7	1,558	55' X 26'6"	7'6"	80	48	150/100	130/110	80/50	40/30	40/36
STUDIO A OR B	779	27'6" X 26'6"	7'6"	40	24	50	50	30	20	20
STUDIO 11	560	28' X 20'	10'	20	12	30	30	20	12	12
LEGISLATIVE TERRACE	1,732	-	-	110	66	200	200	-	-	-
CAPITOL BOARDROOM	450	18' X 25'	7'10"	-	-	-	-	-	-	12
EXECUTIVE BOARDROOM	408	24' X 17'	7'6"	-	-	-	-	-	-	12
SKYE	2,660	-	-	150	90	-	200	-	-	-
BROADWAY KITCHEN	2,070	69' X 30'	9'	100	-	-	-	-	-	-